

# Push Back Racking

Push back racking increases storage efficiency. Multiple carts sit stacked at the front of each line. After a pallet is placed on the top cart, the forklift pushes it back, to expose another cart underneath. Because of the sloped tracks, the rear pallets automatically flow forward when the front pallet is unloaded from the racks.



Push Back Racking is designed for improving storage density and operational efficiency. Pallets are placed on carts, which flowing forward when the front pallet is removed. Push Back Pallet Racking provides highly effective use of space by combining high-density storage with high-speed access. The system offers safe and dense storage for 2, 3, and 4 pallet deep storage, typically up to 5 pallets high. Pallets are gravity fed via the front using conventional handling equipment and retrieved from the same aisle, so the pick face remains constantly full.

All lanes can be accessed from the aisle at any time. The possibility of damage is reduced because the forklift never enters the rack. Push back racking is especially suitable for cold storage due to its high density.



For a more complete view of our product offerings, please contact us.

+1 (909) 670-8888 | [sales@cbmsystem.com](mailto:sales@cbmsystem.com) | [www.cbmsystem.com](http://www.cbmsystem.com)

© 2023 CBM Systems, Inc. and BestPack Packaging Systems. All rights reserved. 230502

## Product Features

- **Storage Operation Style: First In Last Out (FILO)**
- **Large storage quantity for high efficiency of space utility**
- **Suitable for storing varieties & large amount of pallets**

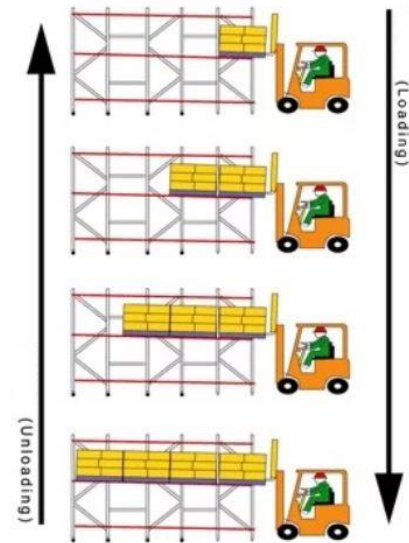
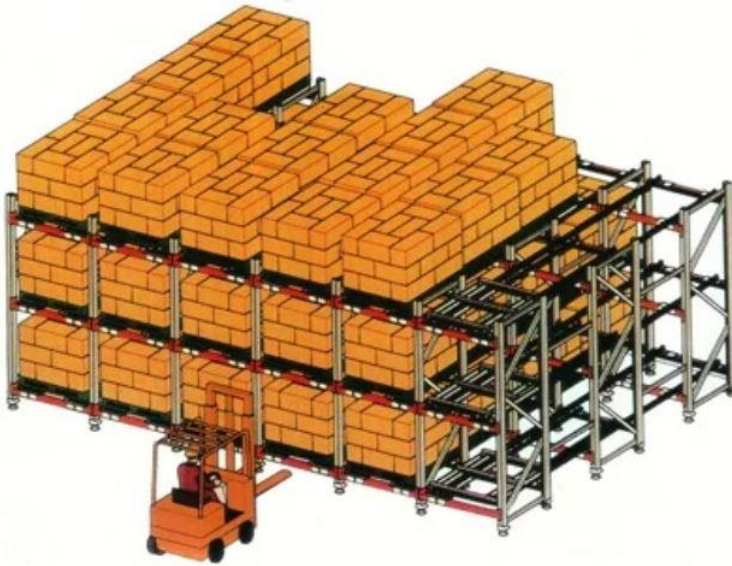

## Advantages

- **Efficient use of space with only some reduction in direct product accessibility**
- **Optimal combination of selectivity and storage density**
- **Sturdy construction yields years of maintenance-free operations**

